



3600 Las Vegas Blvd. So., Las Vegas, NV 89109 • [catering@bellagioresort.com](mailto:catering@bellagioresort.com) • [bellagio.com](http://bellagio.com)

CATERING: DIRECT 702.693.7155 • TOLL FREE 888.434.7711 • FAX 702.693.8575

EVERY WISH, PERFECTLY GRANTED.



MEETING ROOM	SQUARE FEET	DIMENSIONS L' X W'	CEILING HEIGHT	THEATRE	CLASSROOM	BANQUET ROUNDS	RECEPTION (FLOW)	U-SHAPE	HOLLOW SQUARE	CONFERENCE	8' X 10' EXHIBITS	10' X 10' EXHIBITS
No. 2 & 5	18,564	238 x 78	24'	1,870	1,170	1,205	1,205	-	-	-	116	90
No. 3 & 6	5,563	130 x 44	24'	500	285	370	370	-	-	-	30	20
No. 4 & 8	6,680	150 x 45	24'	610	335	430	430	-	-	-	36	24
No. 6 & 7	4,658	108 x 44	24'	495	240	310	310	-	-	-	26	18
No. 7 & 9	4,649	108 x 44	24'	495	255	310	310	-	-	-	26	18
No. 1, 2 & 3	14,516	191 x 76	24'	1,410	855	940	940	-	-	-	87	70
No. 1, 4 & 8	10,553	226 x 45	24'	990	560	700	700	-	-	-	59	40
No. 3, 6 & 7	7,895	184 x 44	24'	655	420	525	525	-	-	-	44	30
No. 4, 5 & 8	20,250	150 x 135	24'	2,175	1,240	1,325	1,325	-	-	-	131	99
No. 6, 7 & 9	6,976	162 x 44	24'	645	375	465	465	-	-	-	38	26
No. 3, 6, 7 & 9	10,212	238 x 44	24'	990	560	680	680	-	-	-	58	40
No. 5, 6, 7 & 9	21,708	162 x 134	24'	2,310	1,325	1,410	1,410	-	-	-	120	109
No. 1, 2, 4, 5 & 8	32,130	238 x 135	24'	3,535	2,050	2,105	2,105	-	-	-	200	179
No. 2, 3, 5, 6, 7 & 9	31,892	238 x 134	24'	3,495	1,935	2,075	2,075	-	-	-	199	166
No. 4, 5, 6, 7, 8 & 9	30,942	191 x 162	24'	3,360	1,875	2,025	2,025	-	-	-	190	151
Stage	2,250	30 x 75	-	-	-	-	-	-	-	-	-	-
Grand Patio	6,082	-	-	-	-	325	325	-	-	-	-	-
Bellagio Ballroom	22,052	149 x 148	24'	2,100	1,230	1,410	1,410	-	-	-	133	106
No. 1	3,150	90 x 35	24'	240	175	210	210	80	90	75	15	15
No. 2	5,670	90 x 63	24'	500	285	360	360	90	110	70	24	24
No. 3	1,540	44 x 35	24'	105	65	70	70	35	40	30	6	6
No. 4	1,610	46 x 35	24'	120	65	70	70	35	40	35	5	5
No. 5	1,750	50 x 35	24'	140	90	110	110	40	50	35	7	7
No. 6	3,150	63 x 50	24'	300	165	200	200	60	75	50	15	12
No. 7	2,030	58 x 35	24'	165	85	95	95	50	55	45	8	6
No. 1 & 2	9,540	106 x 90	24'	935	540	600	600	-	-	-	57	45
No. 1 & 5	5,180	148 x 35	24'	450	270	340	340	-	-	-	25	25
No. 2 & 6	9,324	148 x 63	24'	960	550	595	595	-	-	-	56	46
No. 3 & 4	2,889	90 x 35	24'	260	130	165	165	-	-	-	12	12
No. 5 & 6	5,300	106 x 50	24'	460	255	285	285	-	-	-	32	27
No. 6 & 7	5,300	106 x 50	24'	570	320	385	385	-	-	-	29	24
No. 2, 3 & 4	9,540	106 x 90	24'	915	510	575	575	-	-	-	48	44
No. 3, 4 & 7	4,743	140 x 35	24'	455	220	285	285	-	-	-	18	18
No. 5, 6 & 7	8,642	149 x 58	24'	860	430	550	550	-	-	-	42	35
No. 1, 2, 3 & 4	13,410	149 x 90	24'	1,260	615	865	865	-	-	-	76	64
No. 1, 2, 3 & 6	15,688	148 x 106	24'	1,550	880	1,000	1,000	-	-	-	92	81
No. 2, 3, 4, 6 & 7	15,688	148 x 106	24'	1,550	880	1,000	1,000	-	-	-	86	80
Stage	1,740	58 x 30	-	-	-	-	-	-	-	-	-	-

MEETING ROOM	SQUARE FEET	DIMENSIONS L' X W'	CEILING HEIGHT	THEATRE	CLASS-ROOM	BANQUET ROUNDS	RECEPTION (FLOW)	U-SHAPE	HOLLOW SQUARE	CONFERENCE
Boardroom	690	30 x 23	12'	-	-	-	-	-	-	16
Cézanne	2,580	60 x 43	12'	210	120	160	160	50	60	50
Cézanne 1	1,290	43 x 30	12'	100	65	70	70	30	35	30
Cézanne 2	1,290	43 x 30	12'	100	65	70	70	30	35	30
Van Gogh	1,972	58 x 34	12'	160	75	110	110	50	50	50
Van Gogh 1	986	34 x 29	12'	80	50	50	50	20	25	20
Van Gogh 2	986	34 x 29	12'	80	50	50	50	20	25	20
Renoir	3,740	85 x 44	12'	325	170	215	215	75	80	70
Renoir 1	1,804	44 x 41	12'	170	90	105	105	40	50	35
Renoir 2	1,936	44 x 44	12'	150	80	90	90	30	40	30
Degas	1,887	51 x 37	12'	170	100	100	100	40	50	40
Degas 1	1,073	37 x 29	12'	100	55	50	50	25	30	25
Degas 2	814	37 x 22	12'	70	40	40	40	20	25	25
Gauguin	2,640	60 x 44	12'	210	130	165	165	55	65	50
Gauguin 1	1,320	44 x 30	12'	120	70	70	70	30	40	30
Gauguin 2	1,320	44 x 30	12'	120	70	70	70	30	35	30
Monet	9,570	165 x 58	18'	955	565	650	650	-	-	-
Monet 1	2,378	58 x 41	18'	200	140	145	145	50	60	50
Monet 2	2,378	58 x 41	18'	200	140	145	145	50	60	50
Monet 3	2,378	58 x 41	18'	200	140	150	150	50	60	45
Monet 4	2,436	58 x 42	18'	200	140	145	145	50	60	50
Monet 1 & 2	4,756	82 x 58	18'	460	255	285	285	-	-	-
Monet 2 & 3	5,048	82 x 58	18'	525	285	335	335	-	-	-
Monet 3 & 4	4,814	83 x 58	18'	460	255	285	285	-	-	-
Monet 1, 2 & 3	7,426	123 x 58	18'	780	415	480	480	-	-	-
Monet 2, 3 & 4	7,471	124 x 58	18'	780	415	480	480	-	-	-
Monet Patio	6,365	167 x 38	-	-	-	-	-	-	-	-

Capacity figures do not account for head tables, dance floors, food & beverage buffets, or audiovisual requirements. All functions greater than 300 persons will be subject to Fire Marshal approval.

BELLAGIO CONVENTION AREA

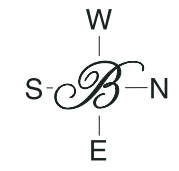
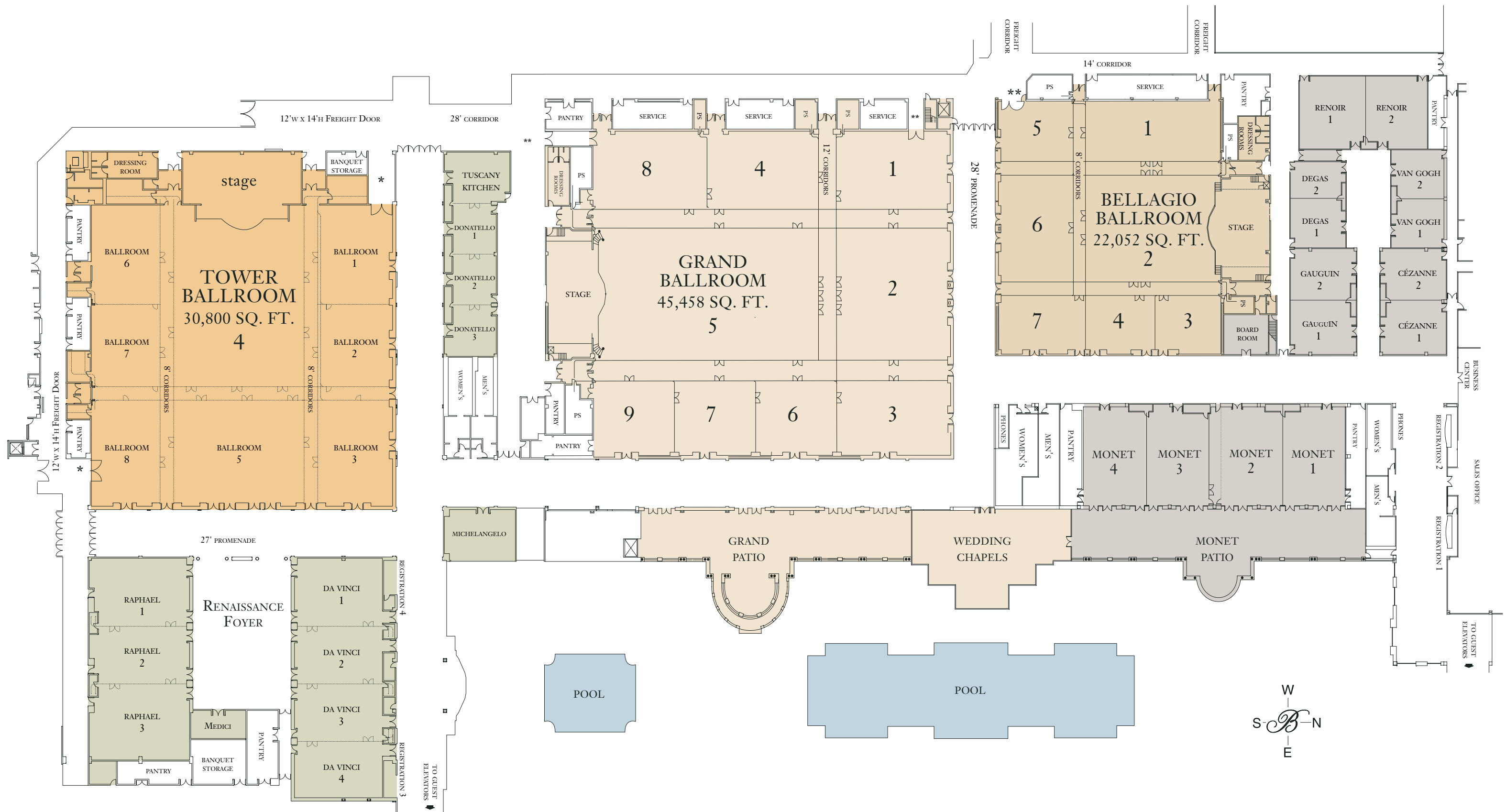

Not to scale. Not to be used for production.

## MEETINGS FACILITIES DIMENSIONS AND CAPACITIES

MEETING ROOM	SQUARE FEET	DIMENSIONS L' X W'	CEILING HEIGHT	THEATRE	CLASSROOM	BANQUET ROUNDS	RECEPTION (FLOW)	U-SHAPE	HOLLOW SQUARE	CONFERENCE	8' X 10' EXHIBITS	10' X 10' EXHIBITS
Tower Ballroom	30,800	176 x 175	24'	3,100	1,870	2,065	2,065	-	-	-	177	153
No. 1	2,494	58 x 43	24'	250	150	170	170	55	65	50	12	8
No. 2	2,107	49 x 43	24'	210	120	135	135	45	55	35	9	8
No. 3	2,623	61 x 43	24'	250	150	175	175	55	65	50	13	9
No. 4	7,811	107 x 73	24'	725	420	480	480	110	135	90	44	32
No. 5	4,453	73 x 61	24'	430	270	295	295	70	95	60	25	16
No. 6	2,494	58 x 43	24'	250	150	175	175	55	70	50	12	8
No. 7	2,107	49 x 43	24'	210	120	140	140	45	60	35	10	7
No. 8	2,623	61 x 43	24'	260	160	180	180	60	70	50	12	9
No. 1 & 2	4,601	107 x 43	24'	410	220	285	285	-	-	-	25	18
No. 2 & 3	5,074	118 x 43	24'	465	270	320	320	-	-	-	29	20
No. 3 & 5	7,564	124 x 61	24'	780	430	500	500	-	-	-	41	32
No. 4 & 5	12,848	176 x 73	24'	1,255	755	840	840	-	-	-	80	56
No. 5 & 8	7,564	124 x 61	24'	780	430	500	500	-	-	-	40	32
No. 6 & 7	4,601	107 x 43	24'	410	220	285	285	-	-	-	27	18
No. 7 & 8	5,074	118 x 43	24'	465	270	320	320	-	-	-	29	20
No. 1, 2 & 3	7,568	176 x 43	24'	700	390	500	500	-	-	-	44	30
No. 1, 2 & 4	13,268	124 x 107	24'	1,300	765	885	885	-	-	-	77	66
No. 3, 5 & 8	10,675	191 x 76	24'	1,170	645	700	700	-	-	-	57	49
No. 4, 6 & 7	13,268	124 x 107	24'	1,300	765	885	885	-	-	-	81	65
No. 6, 7 & 8	7,568	176 x 43	24'	700	390	500	500	-	-	-	44	30
No. 1, 2, 3, 4 & 5	21,824	176 x 124	24'	2,280	1,340	1,445	1,445	-	-	-	136	114
No. 1, 2, 4, 6 & 7	18,725	175 x 107	24'	1,935	1,150	1,250	1,250	-	-	-	116	100
No. 4, 5, 6, 7 & 8	21,824	176 x 124	24'	2,280	1,340	1,465	1,465	-	-	-	140	112
Stage	2,870	70 x 41	-	-	-	-	-	-	-	-	-	-
Renaissance Foyer	5,104	88 x 58	-	-	-	-	-	-	-	-	-	-
Da Vinci	7,228	139 x 52	18'	725	455	480	480	-	-	-	39	36
Da Vinci 1	2,028	39 x 52	18'	175	110	130	130	45	55	40	14	12
Da Vinci 2	1,768	52 x 34	18'	150	110	100	100	40	50	40	11	10
Da Vinci 3	1,664	52 x 32	18'	150	150	100	100	40	50	40	11	10
Da Vinci 4	1,768	52 x 34	18'	150	110	100	100	40	50	40	11	10
Da Vinci 1 & 2	3,796	73 x 52	18'	395	220	250	250	-	-	-	25	22
Da Vinci 2 & 3	3,432	66 x 52	18'	350	220	215	215	-	-	-	22	20
Da Vinci 3 & 4	3,432	66 x 52	18'	350	220	220	220	-	-	-	22	20
Da Vinci 1, 2 & 3	5,460	105 x 52	18'	580	335	360	360	-	-	-	35	32
Da Vinci 2, 3 & 4	5,200	100 x 52	18'	550	335	340	340	-	-	-	33	30
Raphael	6,844	116 x 59	18'	660	380	380	380	-	-	-	41	37
Raphael 1	2,301	59 x 39	18'	205	120	130	130	55	60	45	13	12
Raphael 2	2,006	59 x 34	18'	165	100	130	130	50	55	45	12	11
Raphael 3	2,537	59 x 43	18'	210	130	140	140	55	65	45	16	14
Raphael 1 & 2	4,307	73 x 59	18'	395	220	280	280	-	-	-	25	23
Raphael 2 & 3	4,543	77 x 59	18'	415	240	285	285	-	-	-	28	25
Donatello Ballroom	2,250	90 x 25	18'	195	105	140	140	75	80	75	21	18
Donatello 1	750	30 x 25	18'	55	30	45	45	15	15	20	7	6
Donatello 2	750	30 x 25	18'	55	30	45	45	15	15	20	7	6
Donatello 3	750	30 x 25	18'	55	30	45	45	15	15	20	7	6
Donatello 1 & 2	1,500	60 x 25	18'	130	65	95	95	45	50	45	14	12
Donatello 2 & 3	1,500	60 x 25	18'	130	65	95	95	45	50	50	14	12
Tuscany Kitchen	1,170	39 x 30	-	-	-	-	-	-	-	-	-	-
Michelangelo	1,260	42 x 30	18'	105	60	70	70	30	30	30	-	-
Medici	512	32 x 16	14'	40	30	30	30	-	-	-	-	-
Grand Ballroom	45,458	238 x 191	24'	4,785	2,885	2,970	2,970	-	-	-	279	234
No. 1	3,420	76 x 45	24'	305	165	215	215	70	85	60	17	11
No. 2	5,928	78 x 76	24'	575	330	360	360	90	120	70	32	26
No. 3	3,344	76 x 44	24'	285	165	215	215	70	80	60	16	10
No. 4	3,330	74 x 45	24'	285	165	215	215	70	85	60	16	12
No. 5	11,700	150 x 78	24'	1,215	690	755	755	160	185	130	66	54
No. 6	2,376	54 x 44	24'	215	110	140	140	50	60	45	10	8
No. 7	2,376	54 x 44	24'	215	110	140	140	50	60	45	10	8
No. 8	3,420	76 x 45	24'	305	165	215	215	70	85	65	16	10
No. 9	2,376	54 x 44	24'	215	110	140	140	45	60	40	9	7
No. 1 & 2	10,260	135 x 76	24'	1,020	570	670	670	-	-	-	63	49
No. 1 & 4	7,380	164 x 45	24'	645	365	465	465	-	-	-	39	26
No. 2 & 3	10,184	134 x 76	24'	990	575	660	660	-	-	-	61	48

## SPACE FOR SUCCESS.

The ultimate venue. The elegance of our Five Diamond Award-winning hotel. The world-renowned restaurants. The soothing grace of our Spa and the thought-provoking beauty of our Conservatory. The nightlife. The fountains. "O™" by Cirque du Soleil®.

Special events in our rarefied settings are an artful blend of imagination and sophistication. A dedicated Catering Manager assures continual assistance throughout every phase of the planning, handling your event details with a personalized touch. Our commitment to you and your guests continues with our diligent Banquet Teams on hand to execute every detail with an unrivaled standard of impeccable service.

We find your needs are endlessly varied, so we designed our spaces to be the same way. You'll find a 45,000-square foot Grand Ballroom, a 30,000-square foot Tower Ballroom and our 22,000 square-foot Bellagio Ballroom. For those requiring something more intimate, we also provide 25 more rooms, ranging in size from 1,000 to 10,000 square feet. Our event space provides a stunning setting for events ranging from the most private gatherings to grand celebrations.

Bellagio is famous for its award-winning chefs and culinary artisans who prepare the sumptuous hors d'oeuvres, entrees and desserts for your event. You can choose from any of our exquisitely crafted menus, or we will customize a lavish menu masterfully paired with wines and spirits.

Additionally, our acclaimed team of planners, designers and artists will create any ambience you desire, whether you're having an informal gathering or an opulent celebration. Our professionals and partners will assist you in everything from choosing a theme to designing custom invitations and tailor-made floral arrangements – all intended to make your event an affair to remember.

## PARTNERS FOR THE PERFECT EVENT.

Bellagio gives unparalleled attention to every type of gathering, from weddings and meetings to family reunions and conventions. We've partnered with superlative companies, both in-house and off-property, to complement our high standards.

Your Catering Manager can provide you with more details on these perfect partners.

### MGM MIRAGE EVENTS

This award-winning company has become famous for artistry and ingenuity. Their specialties encompass the wide sphere of corporate concepts, magnificent and flawless wedding designs and themed adventures – all with a signature elegance and flair.

### BELLAGIO HORTICULTURE

The same organically stunning craftsmanship found in our Conservatory & Botanical Gardens can be part of your event. Bellagio's Horticulture team is master of the natural canvas, bringing the Conservatory's aesthetic to your floral arrangements.

### BELLAGIO PHOTOGRAPHY

Your moments are ours to capture – the first wedded kiss, the handshake of a new partnership, the celebration of success. Beyond the posed, our images are infused with life, making them the perfect record of your time with us.

### BELLAGIO TECHNICAL SERVICES

To make you look and sound your absolute best, we rely on audio and visual technology of the highest caliber; and we use it with invention and creativity, to deliver precise acoustics and vivid imagery. So every detail is captured exactly how you remembered it.

